

Three parts mobile platform for campers access

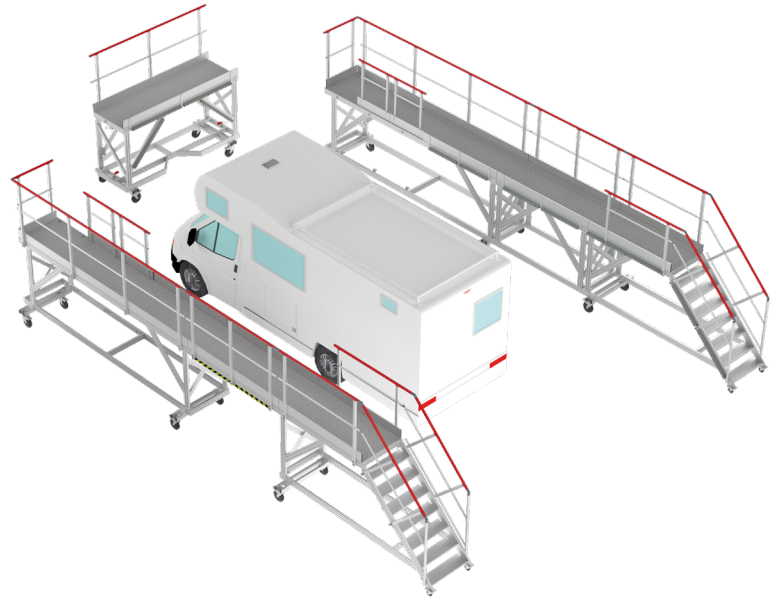

3D view three parts components mobile platform

Mobile platform in three parts for maintenance access / manufacturing of campers. Main structure in raw extruded aluminum profiles 100x30 mm.

Rear mobile platform

- Platform: width: 800 mm x length: 2 520 mm
- Platform coating: aluminum flat sheet thickness 4,4 mm
- Rubber protection on camper side
- Swivel wheels Ø200 mm with brakes
- Guardrail composed of red lacquered handrail (RAL 3000), intermediary rail and baseboard
- Baseboard on camper side
- The platform is attached to the side parts by "grasshopper assembly" – 3 positions possible to adjust the length of the mobile platform

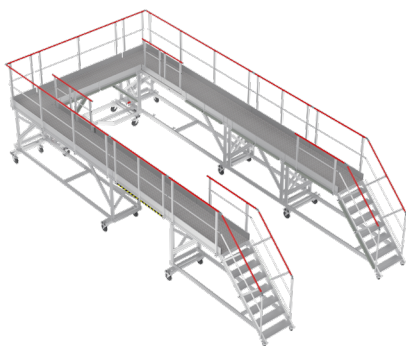

*Rear platform 1st position
length 7000 mm*

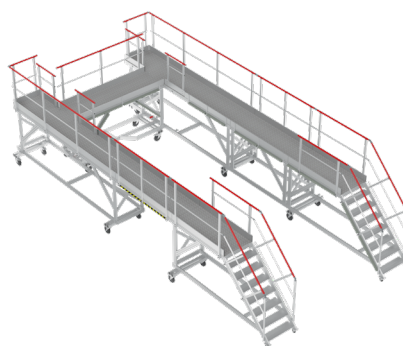

*Rear platform 2nd position
length 6200 mm*

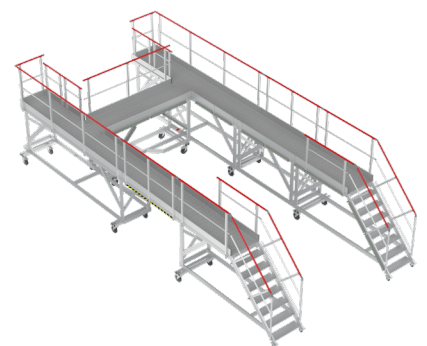

*Rear platform 3rd position
length 5400 mm*

Capacity of load : 300 kg

F892000301 – May 2022

 **FORTAL**[®]
www.fortal.fr
DIVISION TRANSPORT  Made in France

Head Office & Plants : ZI du Muckental – F – 67140 BARR
Phone +33(0)3 88 58 53 53 – Fax +33(0)3 88 58 53 54
www.aeronautique.fortal.fr/en – info@ortal.fr

Three parts mobile platform for campers access

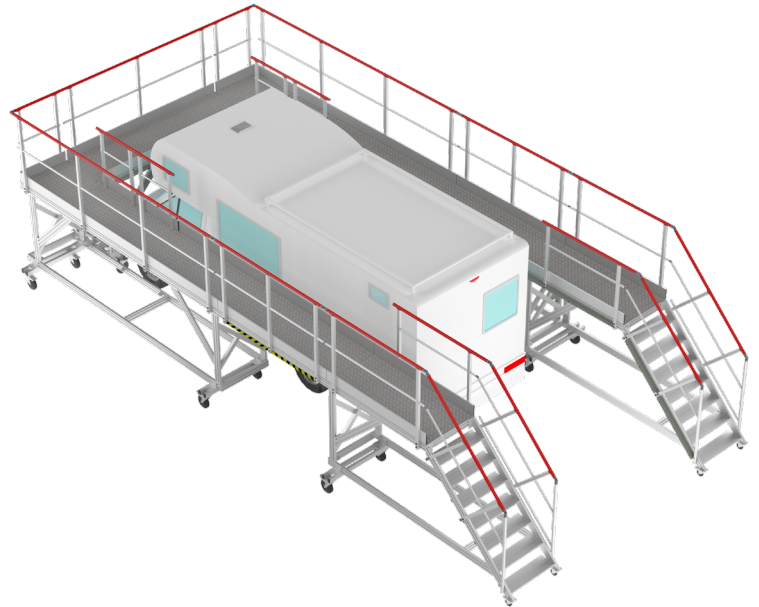

3D view platform in use position

Left and right mobile platforms

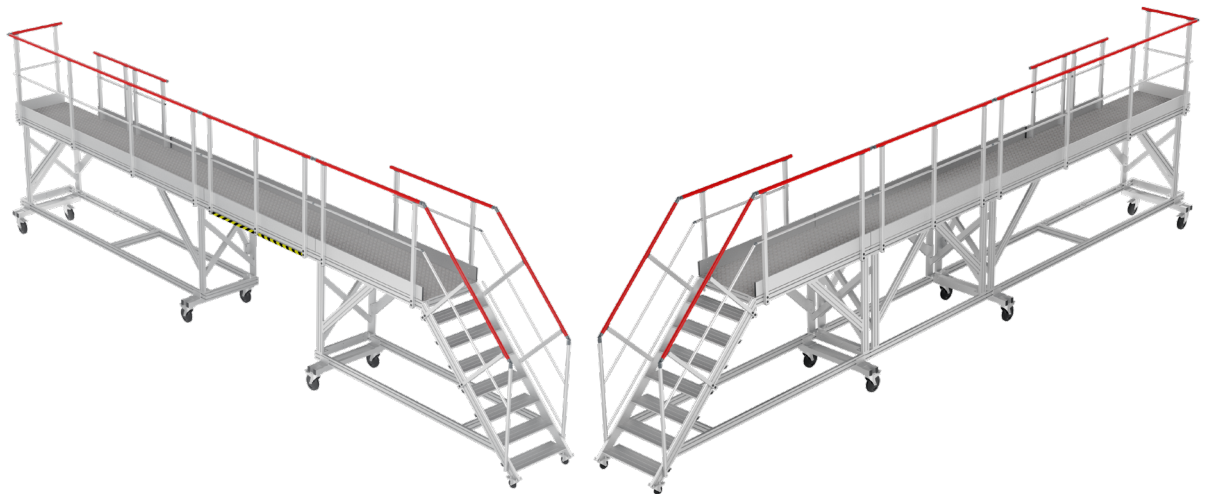

Staircases

- Height to serve: 1 600 mm
- Tilt: 45°
- Useful width: 740mm
- Anti-slip ribbed aluminum steps – depth 230mm

Platforms

- Width: 800 mm x length: 7 800 mm
- Platform coating: aluminum flat sheet thickness 4,4 mm
- Swivel wheels Ø200 mm with brakes
- Each platform is equipped with three removable guardrails (to be put on or remove depending on the position of the rear mobile platform).
- Baseboard on camper side
- Guardrail composed with red lacquered handrail (RAL 3000), intermediary rail and baseboard
- The left platform is equipped with opening to allow the passage of people.

